

Y U M E

Y U M E D X

C o c o o n e d i n c o m f o r t

Y U M E S H A M P O O



YUME SHAMPOO – Taking comfort to a whole new level and surpassing all prior experience at the basin. A new style of shampoo is born for the forward thinking salon.





# Flexibility

The customer reclines to the shampoo position smoothly. As the backrest lowers it mimics the natural motion of a person reclining. With an initial seat height of 480mm the elderly or infirm can use the YUME with ease and comfort. The graceful curves of the chair mean that each customer is cocooned in luxury and comfort.



The comfort of both the customer and stylist were taken into consideration when designing the YUME SHAMPOO. If a longer treatment such as a complete head spa is requested the customer takes advantage of the neck support and the soft seat and the stylist is able to use a stool to which helps maintain a comfortable position.



This unique design enables the stylist to use the basin as either a back or side wash and also from a seated or standing position which means that any type of shampoo or treatment can be offered.

With a seat height ranging from 480 to 830 mm this piece of revolutionary equipment is perfect for any stylist no matter their height.







# MAXIMUM COMFORT

## Perfect for long treatments

Maximum comfort is achieved by the newly developed neck support. Two individual supports, together with the neck cushion mean that the head is supported in 3 different areas creating the perfect balance. This minimises the strain on the neck even if your customer needs to stay at the basin for longer periods of time.

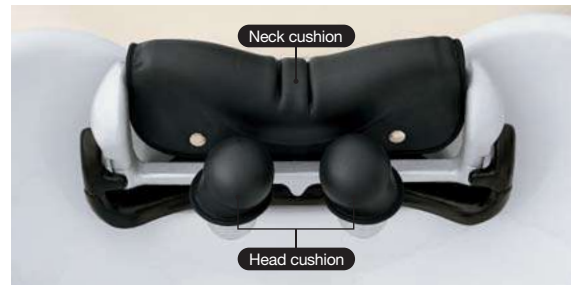

## Function of the neck support

Firstly the neck support rotates on the axis ①. Then the cushion rotates on axis ② in balance with the shape of the head. This 2-axis design adjusts to the contours of the head and helps every customer maintain ultimate comfort.

### [Side view of the neck support]

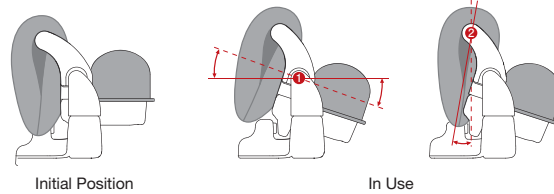

### [Comparison of the pressure distribution between the YUME and MAJOLICA]

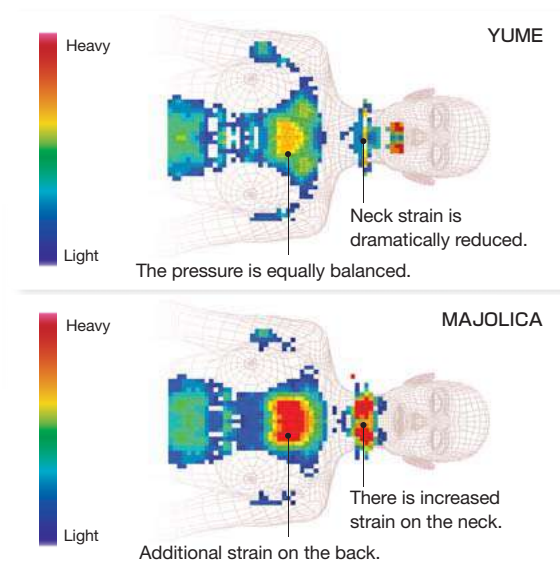





# Features

## All-direction Bowl

The design of the all-direction bowl and the layout of the tap and showerhead make it possible to shampoo from any position including seated and from the rear or side of the basin itself.



## Spacious Bowl and Unique Showerhead

The size of the shampoo bowl has been designed to enable the easy application of treatment. The volume of water supplied means that rinsing can be powerful and efficient and with a contoured shape and graduated design and splash back will be



## Thermostat

For ease and efficiency there is a tap located on both the left and right hand side of the basin. The right hand tap adjusts the temperature of the water and the left the water flow.



## Foot Control

The four way foot control switch enable the operator to change the height and recline of the chair. The switch also features a preset memory, which you are able to programme as well as an auto return function. This feature means that even if your hands are busy at the basin you can change any aspect of the chair without disturbing your customer.



## Upholstery

The upholstery is finished with double stitching, which not only provides superb high quality but also a tactile smooth finish resulting in ultimate comfort for the customer.



## Stool

The stool has been newly designed to allow the best possible working conditions for the operator.

Whilst the stool is in a fixed position its flexibility means that the seat moves with your body to allow you to continue working without moving its location. The height can also be adjusted for the most comfortable working position.



\*OPTION (\*Above images of the stool base differ from the actual product.)

# Colour Options



Black  
SH1



Ivory  
SH15



Dark Brown  
SH24



Brown  
NL12



Camel  
NL22

# Specifications

## Piping diagram

(unit: mm/inch)

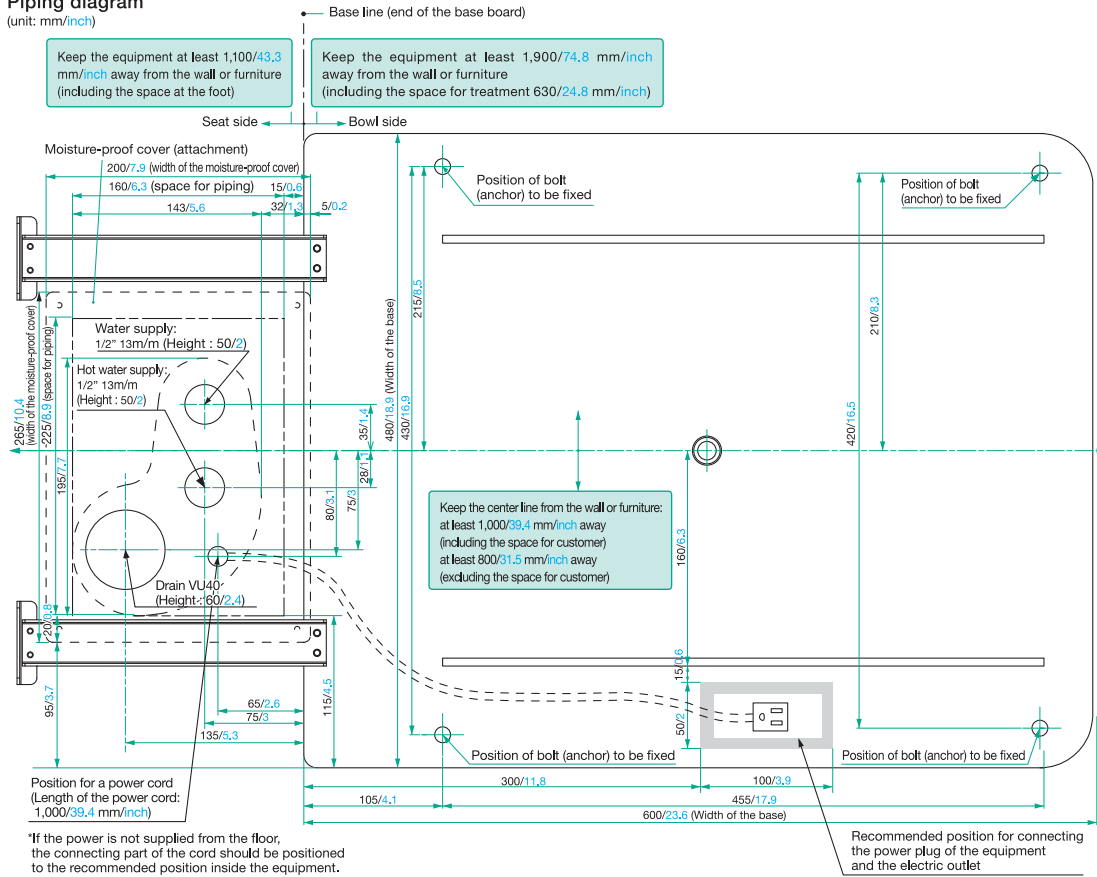

## Dimensional drawing

(unit: mm/inch)

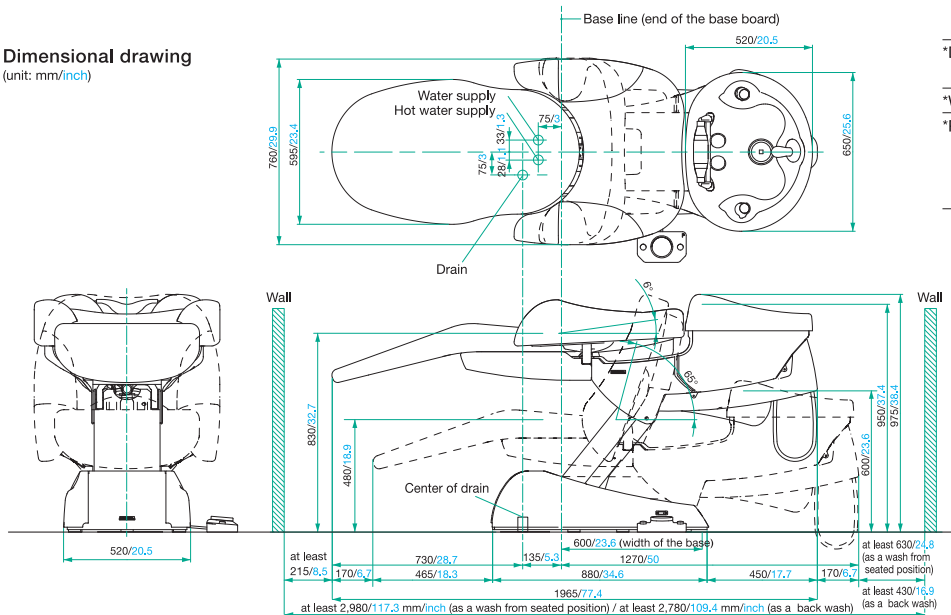

*Dimensions	W760xD1,965xH975mm W29.9xD77.4xH38.4inch
*Weight (unit only)	156kg
*Power Consumption	AC 120V, 50/60Hz, 5.8/4.4A AC 220V, 50/60Hz, 2.1/2.5A AC 230V, 50/60Hz, 2.1/2.4A AC 240V, 50/60Hz, 2.3A

\*The height of the chair is 1,330/52.4 mm/inch when the backrest is in the upright position and elevated to the highest position.

# Y U M E D X



## Ahead of the times The relaxation of the future

No longer do the best salons just offer shampoos and haircuts.

Deepened and diversified relaxation menus are de rigueur.

Salons who provide the more sophisticated “Head Spa” will offer their customers  
complete beauty and respite.

YUME DX is made to realize these ideals in your salon.



# Total Beauty Service

## For deeper relaxation and a warmer spirit of hospitality

### Menu for relaxation and comfort

#### Head Spa

One of the most sought-after salon services, “Head Spa” is a salon-exclusive service offering ultimate relaxation through scalp massage and deep conditioning treatments. The YUME DX ergonomically supports the body for long menu items, offering Head Spa treatments at the highest level.

#### Facial Care

Enhance your salon menu by offering a more comfortable, sophisticated facial. The rotating seat, detachable headrest and movable legrest create a fully flat position. Enhance your salon menu with face and décolleté care.

#### Hand & Nail Care

Hand care and nail care that diversifies your menu. The wide armrests are ideal for manicures and other hand treatments. While the Spa Mist warms up for a Head Spa treatment, take advantage of the extra time to provide hand massage or nail care services. They create new values as additional optional menu items.

#### Massage

Relaxation treatments including massages can easily be provided. By attaching the headrest and rotating the seat, you can easily position your customers for a relaxing massage. The legrest is adjustable to the perfect position for comfort for every customer. Create a unique menu item by using aromatherapy and soft lighting.

### Features



#### The seat rotates 90 degrees, adding variety to the menu

Rotating either clockwise or counter-clockwise, the seat position can be fixed wherever you like, offering you flexibility and variety of treatments including facials and massage.

Seat rotates 90 degrees clockwise OR counter-clockwise.

The backrest can lie flat, between 60 and 90 degrees.



#### The legrest can be adjusted to suit the treatments you provide

Choose the ideal position for the comfort of your customers when sitting or rising from the chair.



#### The detachable headrest accommodates multiple treatments

For facials and massages, the headrest should be attached. It forms a part of the flat-bed and broadens your opportunities for providing a combination of multiple treatments, including head spa and hand care.



#### The foot switch offers convenience and control

Raise, lower, rotate the seat and recline the backrest with the simple foot switch. Preset (P1) and auto-return functions enhance the simplicity of using the Yume. The function that returns the backrest back to the upright position (P2) with one tap of the foot helps you to shift the position from facial treatment to shampoo.

#### Shock absorbers

The smooth up and down movement of the Yume is unparalleled. Shock absorbers dampen any jolts that would otherwise occur so as to not disturb the comfort and relaxation of your customers.





## Specifications

*Dimensions	W760/29.9xD2,000/78.7xH990/39 mm/inch W1,670/65.7xD1,500/59.1xH990/39 mm/inch (with 90-degree rotation)
*Weight (unit only)	205kg (with movable legrest & with headrest)
*Power Consumption	AC 120V, 50/60Hz, 5.8/3.3A AC 220V, 50/60Hz, 1.7/1.7A AC 230V, 50/60Hz, 1.9/1.7A AC 240V, 50/60Hz, 2.2/2.2A

Dimensional drawing  
(unit: mm/inch)

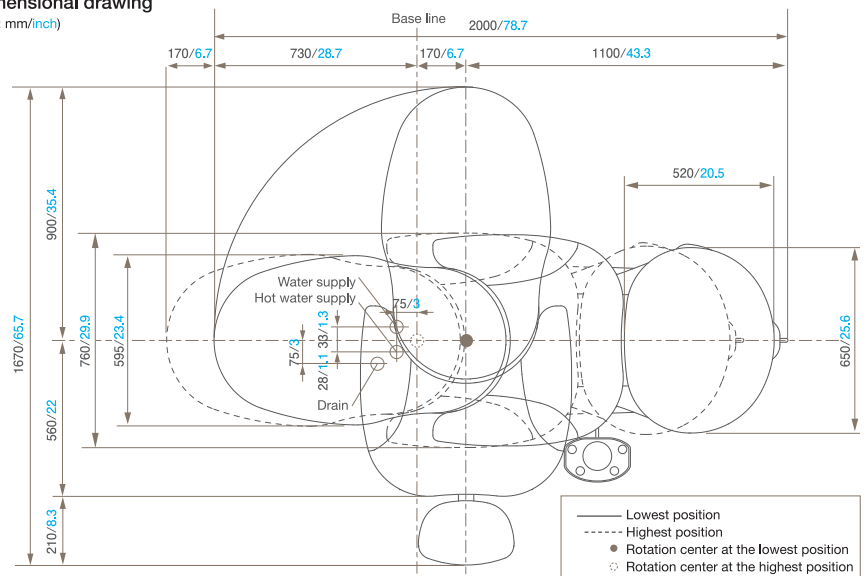

## Minimum Space

Provide maximum service using minimum space.  
Using only 10 m<sup>2</sup>, a variety of treatments can be provided in a comfortable space.

Note: Secure a space of 3000/118.1 x 2700/106.3 mm/inch or wide for the 90-degree rotation. Otherwise, the legs of your customers or the back of your staff might be against the wall.

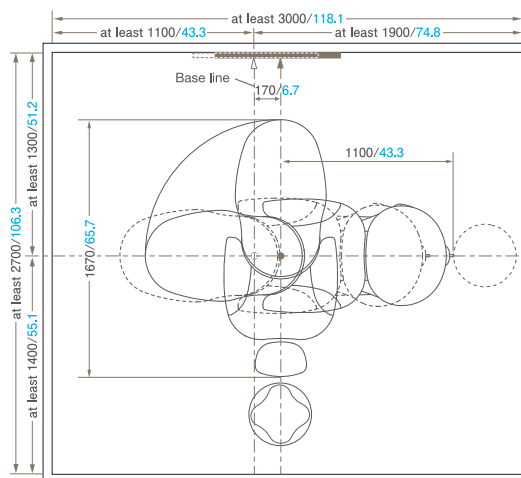

[ Clockwise ]

**TAKARA BELMONT**  
TOKYO · NEW YORK · LONDON · FRANKFURT · PARIS · TORONTO  
SÃO PAULO · SINGAPORE · TAIPEI · SEOUL · SHANGHAI

1-1,2-Chome,Higashi-shinsaibashi,Chuo-ku,Osaka,Japan  
Tel.+81-6-6212-3523 Fax.+81-6-6211-5745  
e-mail : beauty@takara-net.com  
<https://beauty.takarabelmont.co.jp>

\*Actual color may vary from printed color represented in the catalogue.  
\*The manufacturer reserves the right to change the models, descriptions, and specifications without prior notice.

